



KIMBERLEY QUEST



BEYOND ADVENTURE



BEYOND ADVENTURE

Kimberley Quest's range of Kimberley cruises will take you to some of the world's most remote, untouched and spectacular areas that only a select few are lucky enough to experience.

One of the world's last unique wilderness areas, this truly unforgettable landscape can be explored aboard the *Kimberley Quest II*. Join us on our journey as we explore and wonder at a land of extraordinary contrast and colour, rich in history, ancient Aboriginal rock art and breathtaking scenery – an experience that is truly beyond adventure!



THE KIMBERLEY QUEST II

The Kimberley Quest II has been designed for relaxing and exploring the Kimberley coastline in complete comfort and style.

Our custom-built vessel is fully air-conditioned, equipped with a helipad, spa and large ensuited cabins. The vessel has comfortable indoor and spacious al fresco areas so there is plenty of room to take in the panoramic scenery and breathtaking sunsets. Accommodating just 18 guests and 6 crew, your holiday of a lifetime can be enjoyed with fellow travellers in luxurious and intimate surrounds.



CRUISING THE KIMBERLEY



Kimberley Quest will give you the opportunity to explore the natural beauty of this unique and remote coastline, visiting stunning islands, thundering waterfalls and towering rugged cliffs. You will cruise along ancient river systems that are teeming with fish and view ancient Aboriginal rock art including Wandjina and Gwion Gwion art, tucked away in natural caves. Not to mention the amazing array of wildlife, hidden rainforests and stretches of white sandy beaches with not a footprint in sight! The *Kimberley Quest II* carries three excursion tenders and a shaded fast boat, so days are filled with a myriad of activities both on and off land, exploring the spectacular region with your very own local guide, who has extensive knowledge of the Kimberley coastline. During your cruise you are free to do as much or as little as you wish.

OUR CREW



Over 28 years we have created a dynamic and thriving business, primarily built around our knowledge of both the Kimberley region and a highly successful background in owning and managing marine based operations. Our focus is to ensure that we provide the highest quality of operations and exceed guest expectations throughout all aspects of the company.

The crew have a wealth of knowledge and are there to share their amazing insights of the Kimberley region with you. They are experienced in their roles, friendly and most importantly, passionate about the Kimberley's deep history, culture and ecology.

From ensuring you have everything you require on and off the boat, to helping you land a huge fish, our crew take great pride and pleasure in making your cruise experience last in your memory for a lifetime!

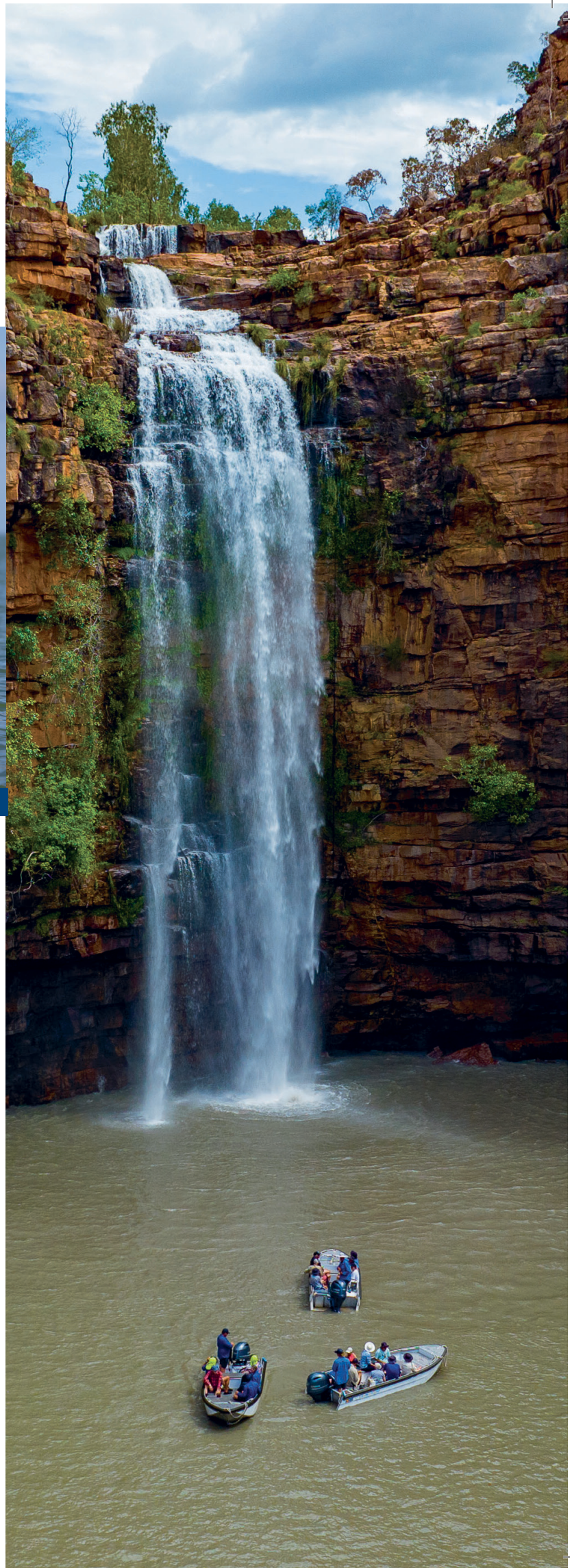



ONBOARD EXPERIENCE

Features and facilities of the *Kimberley Quest II* complement the magnificent countryside you visit and explore. The vessel is complete with spectacular viewing points, including a large sun deck with sun lounges and a spa. An open planned wheelhouse where you can talk with the Captain and find a comprehensive library of reference books and Kimberley stories. Sit down and enjoy a delicious meal in our air-conditioned saloon with full length viewing windows, or simply relax at our huge outdoor table perfect for dining, reading or chatting with newly formed friends with the stunning and ever-changing Kimberley backdrop surrounding you.

ONBOARD FEATURES & FACILITIES

.....

3 tender vessels and a shaded fast boat for excursions | Helipad | Spa | Indoor and outdoor entertaining areas
 | Large ensuited cabins | Extensive library | Satellite Wifi cards | Navigational viewing system
 | Quality sound system | Board games | Open wheelhouse | Open galley

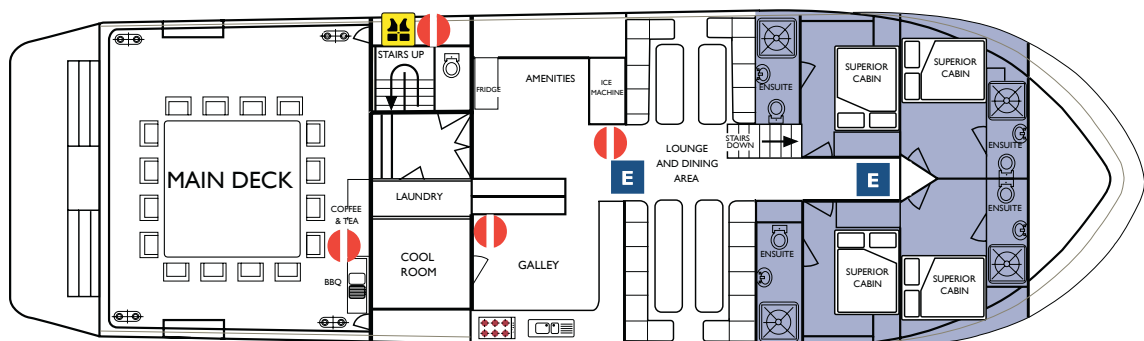
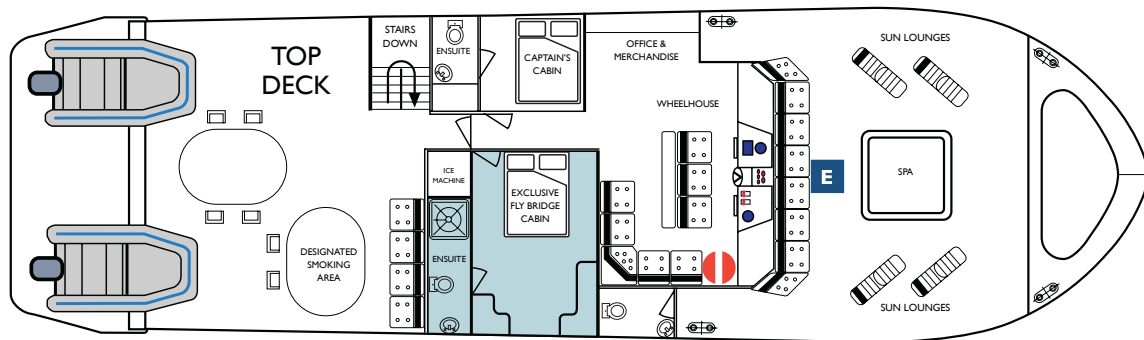

D

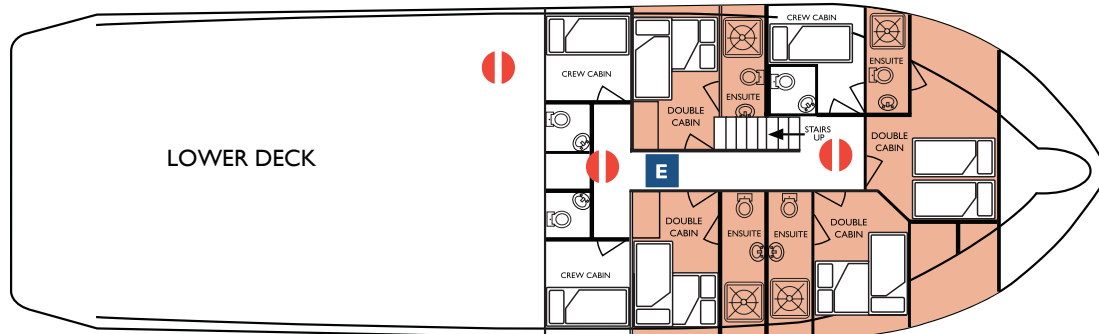



Each cabin includes its own large private ensuite with hair dryer, individual air-conditioning, personal mini-fridge and viewing window. Storage in your cabin consists of a closet with hangers, a cupboard, and a space for stowage underneath your bed. Cabins are serviced daily.

FLYBRIDGE CABIN

Our exclusive flybridge cabin is the only guest cabin on the top deck and features a queen size walk-around bed, as well as a large viewing window. This is our most luxurious cabin and provides the ultimate in onboard comfort.



SUPERIOR CABINS

Our superior cabins are located on the main deck and feature a queen size bed and large viewing windows. This option is well suited to guests who wish to add a little indulgence to their onboard stay.



DOUBLE CABINS

The double cabins are located on the lower deck and feature a double size bed with an additional single bed above. For guests who would like to stay in our double bed cabins and would prefer separate bedding, you can opt to use the additional single bed in your cabin or we have one cabin which can be arranged into twin single bed configuration subject to availability.



*Please note, the layout of our cabins can vary from the picture shown.





BEYOND IMAGINATION

OUR CRUISES

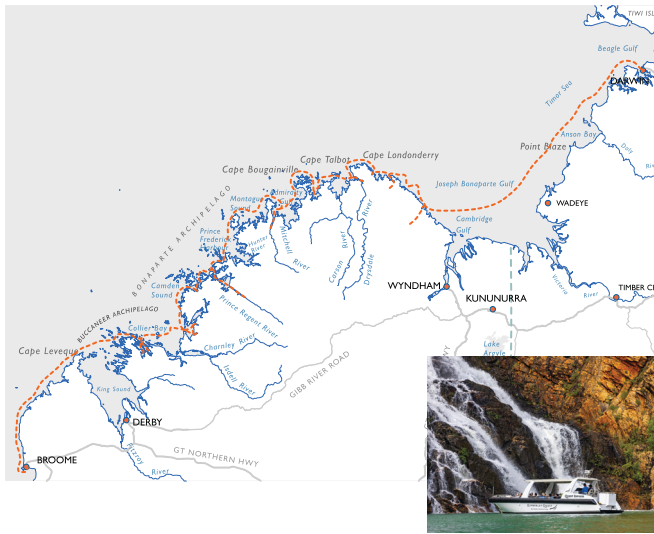

21 DAY BEYOND ADVENTURE

Expedition departing from Broome, is set to capture the spectacular Kimberley waterfall season. This itinerary allows extra time to explore the enormity of the vast Kimberley coastline. Cruise the steep gorges and experience the sheer power of the long drop waterfalls in the north, visit fascinating historical sites of WWII, ancient rock art sites and lost cities. You will fish for the elusive Barramundi and many other fish species as well as enjoy refreshing dips in pristine waterholes. As you head north you will visit many renowned icons of the Kimberley including the famous Horizontal Falls, Montgomery Reef and King Cascade. Disembarking in Wyndham you will have experienced an amazing 21 days on one of the most extensive itineraries in the region!

*Operates February to March.
Starts Broome, ends Wyndham.*

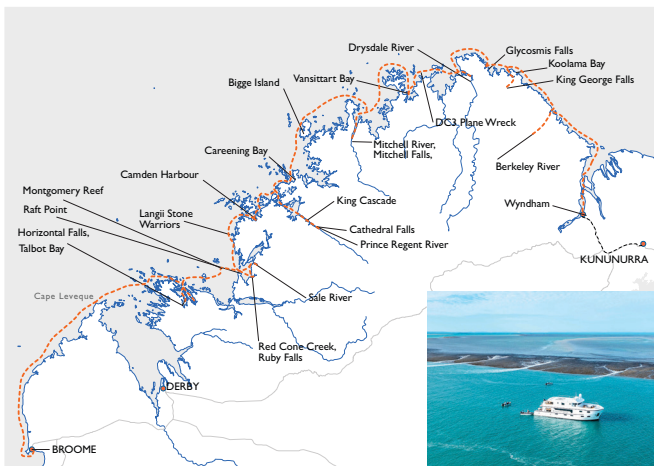

14 DAY ULTIMATE QUEST

This is the ultimate wilderness cruise along the whole Kimberley coast. Cruising between Broome and Wyndham, this adventure really does have it all; witness amazing Kimberley icons such as King George Falls, Berkeley River, Montgomery Reef and the Horizontal Falls to name a few. Enjoy refreshing swims in fresh water holes, explore historical Aboriginal art sites, fish for the elusive Barramundi plus many other fish species and view majestic gorges. This cruise operates just after the wet season when the waterfalls are spectacular!

*Operates March to June.
Starts Broome, ends Kununurra or vice versa.*

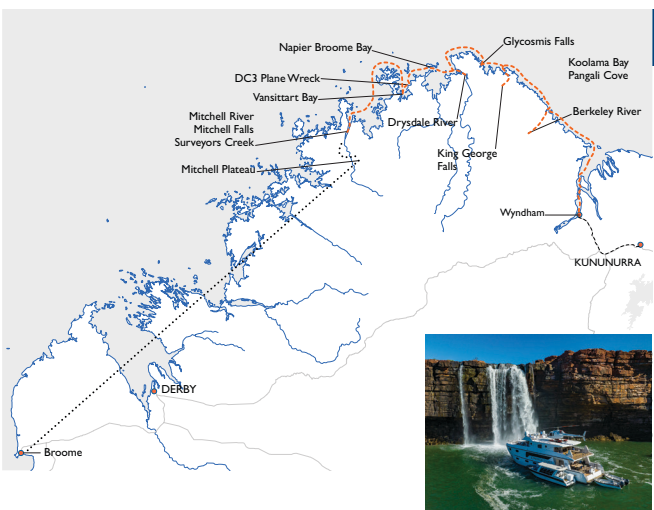

8 DAY NORTHERN QUEST

Renowned for its massive gorges and river systems, extensive waterfalls, World War II relics and incredible Gwion Gwion rock art sites, the northern Kimberley is an experience not to be missed. Exploring between Wyndham and the Mitchell River, this cruise will visit Kimberley icons such as the King George Falls, Berkeley River, Drysdale River and many more. Enjoy refreshing swims in fresh water holes, explore historical Aboriginal art sites, fish for the elusive Barramundi plus many other fish species and view majestic gorges. This cruise operates just after the wet season when the waterfalls are spectacular! This quest also includes a scenic flight over the Mitchell Falls.

*Operates April to May. Starts Broome, ends Kununurra or vice versa.
Includes scenic flight transfer and helicopter flight.*

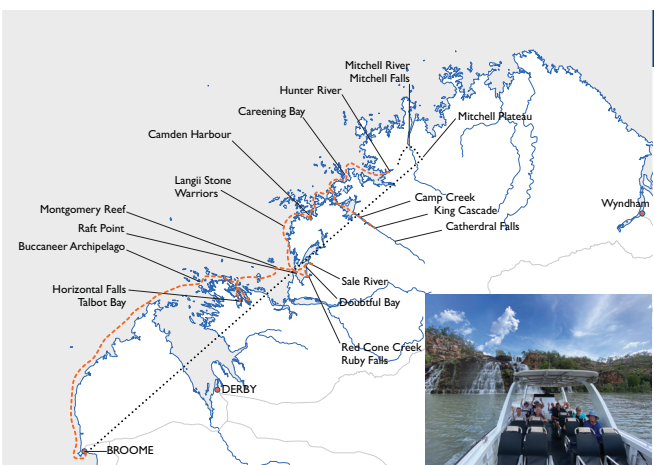

8 DAY SOUTHERN QUEST

Many icons of the Kimberley can be found in the stunning southern region. This area is prolific with islands, whirlpools, inlets and pockets of rainforest home to many species of birds and other wildlife. You will explore a land of extraordinary contrast and colour, rich in history, ancient Aboriginal rock art and breathtaking scenery. We visit the famous Horizontal Falls, Montgomery Reef and King Cascade – a spring fed waterfall in the Prince Regent River as well as many other Kimberley icons. This quest also includes a scenic flight over the Mitchell Falls.

*Operates June to September. Starts Broome, ends Broome.
Includes scenic flight transfer and helicopter flight.*

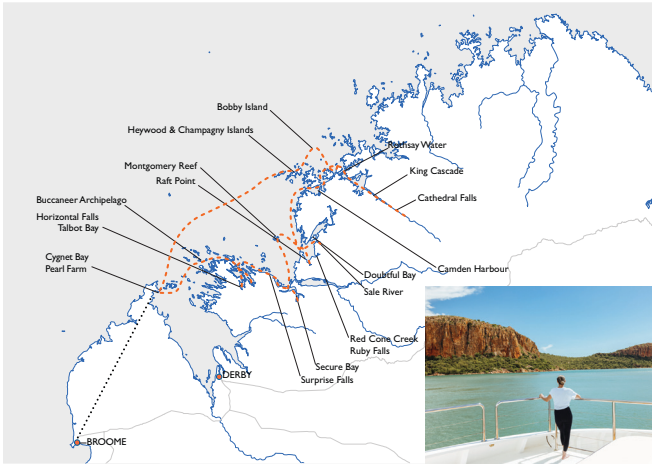

10 DAY ADVENTURE QUEST

The 10 day Adventure Quest is an extensive exploration of the southern Kimberley, visiting many unknown sights, rarely visited islands, inlets and 'secret spots'. Enjoy pristine beaches, secluded fresh water swimming holes, ancient Aboriginal art sites, fishing for Barramundi and many more fish species. Visiting icons such as the Horizontal Falls, Montgomery Reef and King Cascade to name a few. Your cruise takes in all there is to offer of the southern Kimberley region allowing you to explore many breathtaking areas, discover the deep history of the region and enjoy unforgettable scenery. *Operates August to September. Starts Broome, ends Broome. Cruises include transfer to/from Broome.*

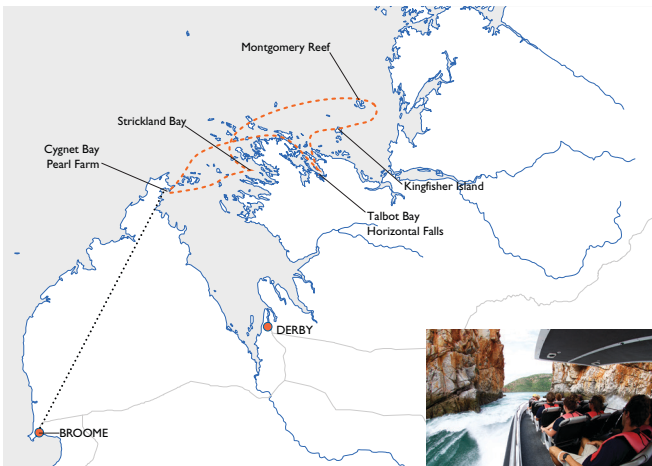

4 DAY TASTE OF THE KIMBERLEY

This 4 day cruise offers a taste of our renowned Quest itineraries and will see you visit some of the breathtaking scenery within the southern Kimberley. The 'Taste of the Kimberley' will have you touring a fully operational Australian South Sea Pearl farm, cruising through the thousand islands of the Buccaneer Archipelago and visiting icons including the famous Horizontal Falls and Montgomery Reef; Australia's largest inshore reef. You will have the opportunity to try your luck at fishing in the pristine Kimberley waters. Exploring this region aboard the well-appointed Kimberley Quest II, accompanied by our luxury fast boat Quest Express, will leave you with the taste for more! *Operates October. Starts Broome, ends Broome. Cruises include transfer to/from Broome*

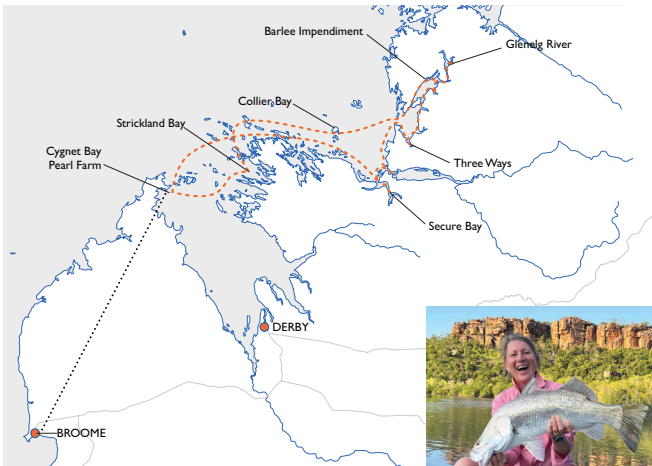

FISHING EXPEDITIONS

Offering some of the best fishing in the world, spectacular scenery and perfect weather the Kimberley is undoubtedly a very special place. Isolated and remote, this true wilderness country encompasses rugged gorges, towering sandstone escarpments, meandering river systems and immense estuaries. The waters are teeming with many species of fish including Barramundi, Mangrove Jack, Fingermark Bream, Salmon, Giant Trevally and more. We take a maximum of 12 guests on our fishing expedition to ensure there is plenty of space in our tenders. Each tender is driven by knowledgeable and enthusiastic guides who will use their experience to help you land the 'big ones!' *Operates October. Starts Broome, ends Broome. Cruises include transfer to/from Broome*

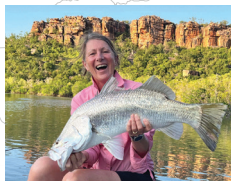

PRIVATE CHARTERS

Any available cruise can be customised for an exclusive experience for your private or corporate group. Fantastic savings are available for private charters and the itinerary can be tailored to suit your group's preferences. A cruise with friends and family makes an amazing experience even more memorable!



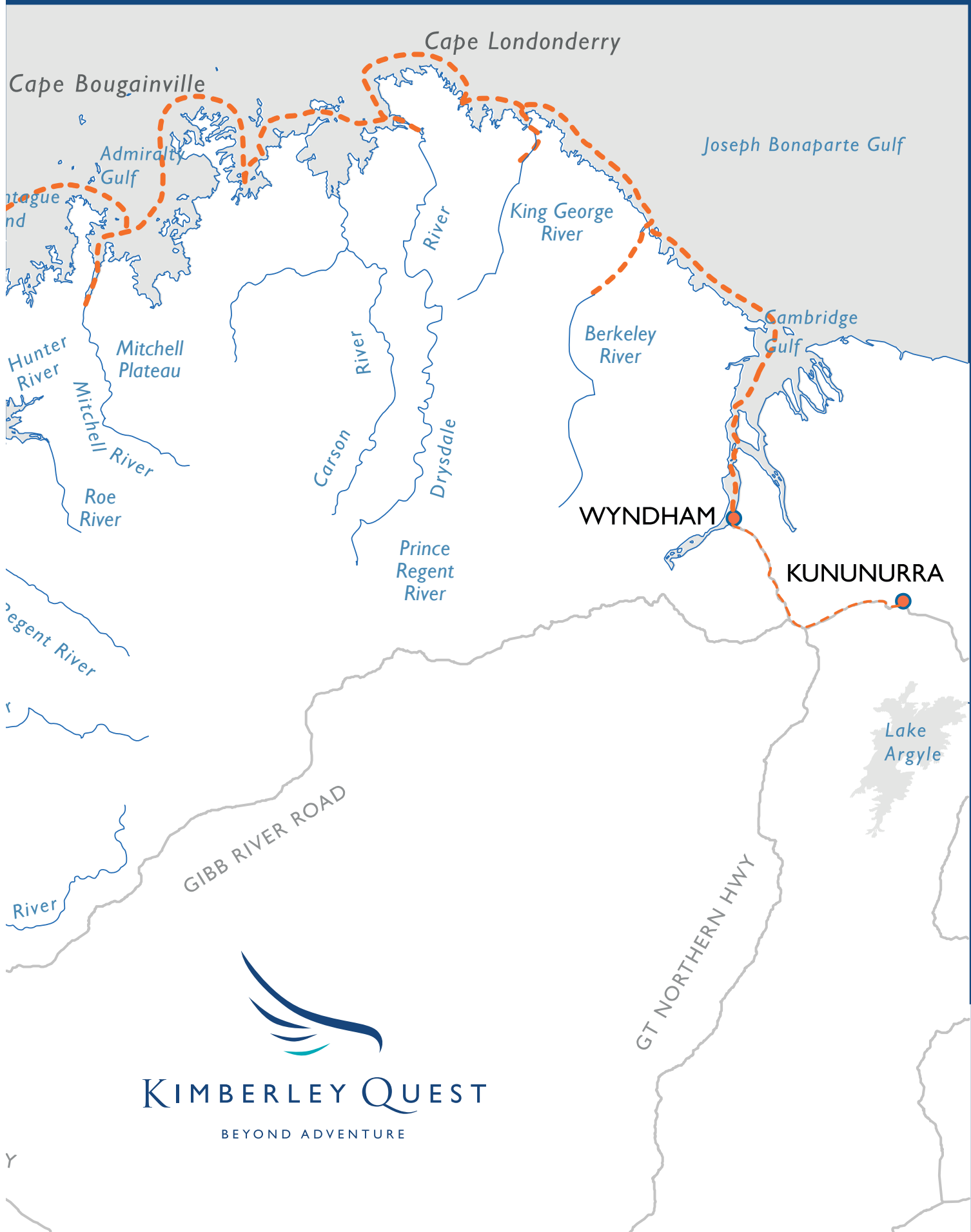

KIMBERLEY QUEST
 BEYOND ADVENTURE

Y

EXCLUSIVE PRIVATE CHARTERS



Our expeditions are the ultimate in adventure cruising and the Kimberley is a land of extraordinary contrast, colour and breathtaking scenery. A cruise with friends and family makes an amazing experience even more memorable!

Any available Kimberley cruise can be tailored to a private charter for your exclusive or corporate group. Exclusive boat occupancy means the itinerary can be changed to suit your group's preferences, whether it be wildlife, walking, fishing, Aboriginal art, or a combination of all of these.

You can also tailor the daily excursions to suit the interests of your group or rely on our experienced captain to guide you to our favourite areas. The ideas are endless when you have the most extraordinary location at your fingertips!







ACTIVITIES

TENDER EXCURSIONS

WALKS

ANCIENT ROCK ART



Every onshore expedition consists of an interesting and sometimes exhilarating tender excursion. View mangrove habitats, spot crocodiles basking on the mudflats, bird watch, fish, and experience the natural beauty of the Kimberley. Sightseeing from the comfort and safety of the *Kimberley Quest II* excursion vessels, which consist of three 5 metre tenders and the 11 metre shaded *Quest Express*.



Throughout your cruise you will visit places of historical, cultural and scenic interest, including the 1820 Mermaid boab tree, 1864 Camden Harbour settlement, King Cascade and many other exciting areas where there is the option to walk and explore with your guides. Treks vary in difficulty and your crew will advise you accordingly.



Some of the best Wandjina and Gwion Gwion (or Bradshaw) art sites can be viewed throughout your cruise. Wandjina art can be seen along the whole of the Kimberley coastline whilst the enigmatic Gwion Gwion art is located predominantly in the northern region. Be amazed by the different epochs and art styles and learn the ancient stories behind them.



FISHING

SWIMMING

WHALES AND MARINE LIFE



Our fishing activities have no rigid daily schedule, the captain and guides decide what areas will offer the best opportunities on each day. It is important to us that sustainable fishing is practiced, with only enough fish for the table kept. Mangrove Jack, Threadfin Salmon, Spanish Mackerel and Queenfish are among the fish species caught, not forgetting the prized Barramundi!



Swimming is an integral part of the cruise itinerary. Wherever possible our guides plan expeditions which include an opportunity to cool off in pristine picturesque spring-fed waterholes.



Majestic Humpback Whales train their newborn calves in the warm Kimberley waters from July through to September. These magnificent mammals can often be seen frolicking from the bow of the *Kimberley Quest II*, making for fantastic photographic opportunities. Also view an abundance of other marine life including the Australian snubfin dolphin, dugongs, turtles and sea snakes in their natural habitat.

QUEST CUISINE



Cuisine on board the *Kimberley Quest II* is simply delicious. All meals are prepared by our talented chef in the fully equipped open galley, offering an array of fresh fish, seafood, the highest quality meats, freshly baked breads and some of the best local produce.

The menu is designed with variety in mind and you can expect a minimum of three meals each day with tasty treats and snacks in between. When our guests catch fresh fish, oysters or crabs, you can expect to see them transformed into an inspired gourmet creation on the menu!

With prior arrangement our chef is equally able to create special gourmet selections to cater for dietary requirements and special needs.





YOUR QUEST

Your quest is to embrace the opportunity, explore the land and to discover the amazing array of sights and sounds of the Kimberley region. Enjoy the comfortable facilities on board *Kimberley Quest II*, the personalised service from our crew and the company of your fellow travellers and new found friends. What cruise will you choose to begin your quest?

'A truly memorable lifetime experience. I wish I had the words to describe how wonderful the cruise was.' Paul & Anne - 14 Day Ultimate Quest

'Wow what a trip, absolutely loved every minute of this and so sad that it is finished! Far surpassed my expectation considering I had already done a cruise up here before. The helicopter delivered a wonderful addition to the trip. We loved all the staff. Crew fantastic and totally dedicated to their job and us! Thank you, team.' John & Dianne - 14 Day Ultimate Quest

'The crew were very well versed on the environment and history of the areas we visited. They all felt an affinity with the localities. The crew went beyond the call of duty to make our holiday one of the best ever.' Andrew & Carolyn - 8 Day Southern Quest

'The staff on this trip would have to be the best we have ever encountered on any trip. Really amazing. The way they made sure everyone could participate in everything, helping the ladies who didn't think they could climb up that rock or cast that line. It was really nice to watch. The knowledge they all had of the area was amazing & they are all just down to earth. You have a great ship but really the staff are without a doubt your greatest asset.' Steve & Kylie - 10 Day Adventure Quest



08 9193 6131
 cruise@kimberleyquest.com.au
 kimberleyquest.com.au
 PO Box 2838, Broome WA 6725
 14 Tanami Drive, Broome, WA, 6725

ABN 27 953 718 722 ACN 160 675 374



BEYOND OUR BRAND



On any Kimberley Quest cruise you will witness and be transfixed by the magnificent White-Bellied Sea Eagle. Our logo emulates the spirit of flight and freedom that this spectacular bird enjoys. Our positioning statement, 'Beyond Adventure' is our pledge to deliver every guest with a Kimberley experience that goes beyond imagination and a level of comfort and service that goes beyond expectation.

